

REV.	APPR. BY	DATE

REV.	APPR. BY	DATE

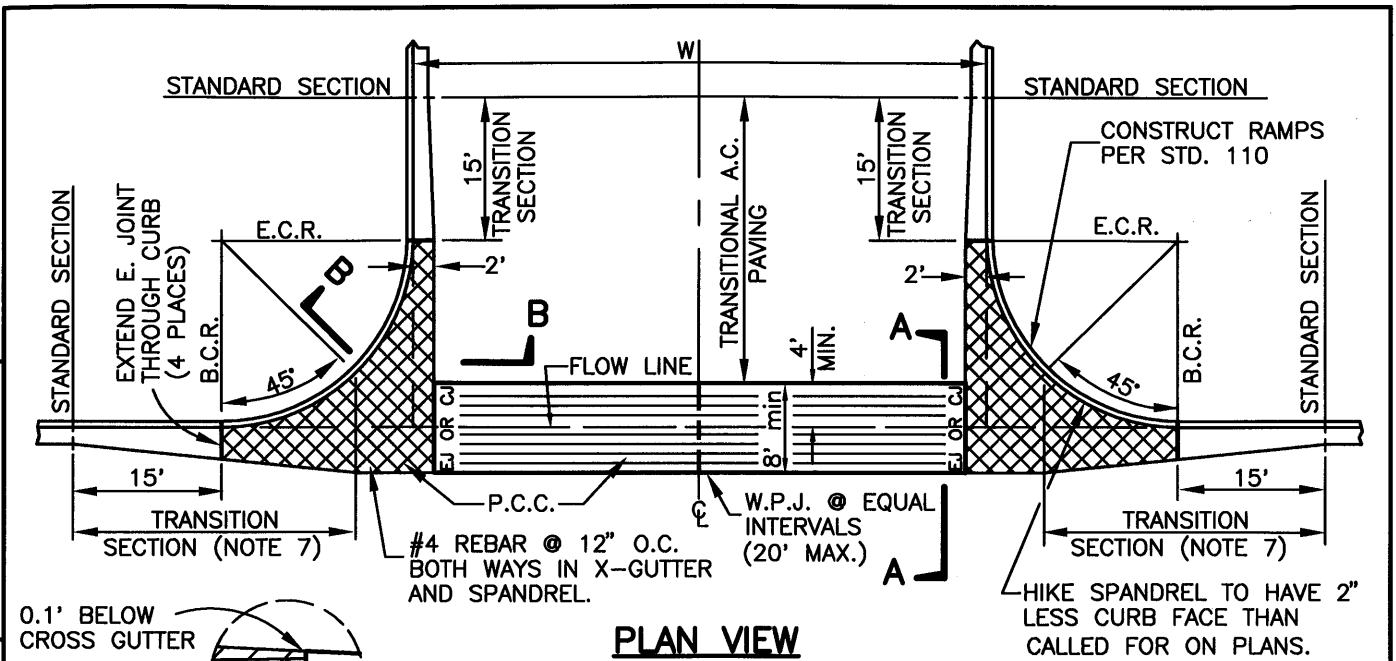

0.1' BELOW CROSS GUTTER

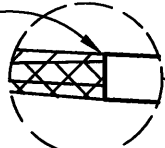

PLAN VIEW

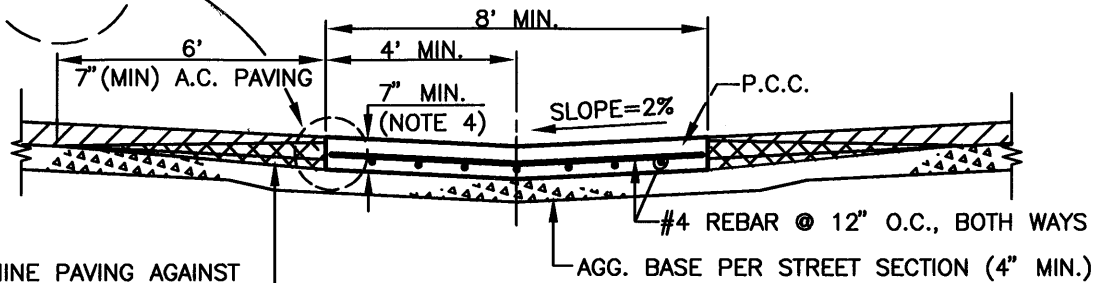

SECTION A-A

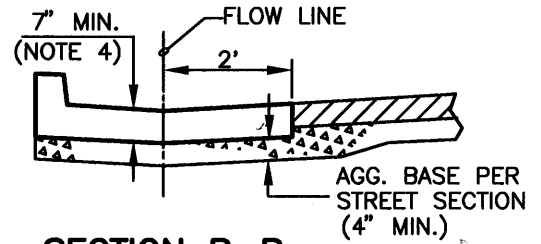

SECTION B-B

PRIOR TO MACHINE PAVING AGAINST PCC X-GUTTER, A WEDGE OF AC 6' IN WIDTH MUST BE PLACED BY HAND, AS INDICATED, TO PREVENT MACHINE DAMAGE TO GUTTER, (BOTH SIDES). TACK EDGES OF X-GUTTER WITH TACK COAT SS-1H. AC WEDGE TO BE PLACED 7 DAYS AFTER X-GUTTER HAS BEEN POURED.

NOTES:

1. AGGREGATE BASE REQUIRED UNDER CROSS GUTTER BEGINNING AT B.C.R. & E.C.R. & UNDER SPANDREL.
2. ——— INDICATES COLD JOINT (CJ) OR EXPANSION JOINT (EJ).
3. - - - INDICATES WEAKENED PLANE JOINT 2" DEEP TO BE PLACED WHEN W IS GREATER THAN 20'.
4. CROSS GUTTER & SPANDRELS THICKNESS SHALL BE 8" FOR CROSS GUTTER WIDTH OF 16', 18', AND 20'.
5. STEEL REINFORCING SHALL BE #4 BARS AT 12" O.C. BOTH WAYS IN CROSS GUTTER & SPANDRELS.
6. CROSS SLOPE OF CROSS GUTTER TO FLOW LINE SHALL BE 2%.
7. TRANSITION SECTION SHALL BE INCREASED BY 2' FOR 2' INCREMENTS FOR CROSS GUTTER WIDER THAN 8'.
8. CONSOLIDATE CONCRETE USING A VIBRATOR.
9. ALL CONCRETE SHALL BE CLASS 520-A-2500 WITH 2LBS OF 3/4" LONG POLYPROPYLENE FIBERS PER CUBIC YARD.



CROSS GUTTER & SPANDREL		STANDARD PLAN 2002
DRAWN: STAFF	CKD.: STAFF	PLATE 114
<i>Department of Public Works</i>		
APPR. L. Balderrama, PE, City Engineer		SHEET 1 OF 1