

**SIGN PROGRAM FOR  
MCGRATH BUSINESS  
INDUSTRIAL PARK**



## **SIGN PROGRAM FOR THE MCGRATH BUSINESS INDUSTRIAL PARK**

### **1.1 Applicability**

This sign program shall apply to Buildings I, II and III as shown on the attached map also known as the McGrath Business Industrial Park (Exhibit 1-1).

### **1.2 Purpose and Intent**

The purpose of this Planned Sign Program is to provide for adequate and attractive identification of buildings and businesses by ensuring proper design, location and maintenance of all signs and graphics within McGrath Business Industrial Park.

### **1.3 Maintenance**

All signs within the McGrath Business Industrial Park shall be maintained in good condition. Property management shall be responsible for making periodic inspections to ensure that all signs meet this provision. Any deficiencies shall be corrected immediately by the person or business responsible for said sign or signs.

### **1.4 Approval**

All new signs shall have the written approval by the property owner and/or property manager prior to submittal to the City of Oxnard.

### **1.5 Submittal Requirements**

Submittal requirements as specified in the planning application materials.

### **1.6 Compliance Required**

No person shall erect, enlarge, alter, move, improve, remove, convert or equip any sign or sign structure, or cause or permit the same to be done contrary to or in violation of the provisions of this sign program or the governing sign code. Conformance will be strictly enforced by the property management company and the City of Oxnard. All such nonconforming or unapproved sign(s) must be brought into conformance at the expense of the persons responsible for the installation of said sign(s).

### **1.7 General Sign Standards**

The following table provides a summary of the general sign standards:

Criteria	Allowed
Sign Types Permitted	Monument sign (One currently existing on the northwest corner of Rose/Lockwood) Wall signs (As stated in Section 1.8). No can signs shall be allowed.
Letter style	Either 12" or 18" individual foam/channel letters in helvetica medium font. Letter sizes shall not exceed 18" in size.
Color Standards	Color of signs shall be mcgaelic green (blue/green).
Illuminated/Non-Illuminated Signs	Both illuminated and non-illuminated signs shall be permitted.

**1.8 Specific Design Standards**

The following table provides a summary of the specific design standards:

Criteria	Allowed
Monument Sign	Double faced sign - 7 feet in height and up to 32 square feet in sign area per sign face. Letter style and font shall be consistent with standards in Section 1.7 (Letter style). Existing location at the northwest corner of Rose Avenue and Lockwood Street.
Tenant Wall Signs (Primary)	The permitted sign area for a primary wall sign shall not exceed two (2) square feet of sign area for each lineal foot of building not to exceed the letter sizes in Section 1.7. Primary wall signs shall be placed above the door of each unit space and/or centered across the lineal frontage of each individual unit.
Tenant Wall Sign (Secondary)	A second wall sign may be allowed on a secondary elevation for tenants which have a second building frontage. The permitted sign area for a secondary wall sign shall not exceed one-half (1/2) square foot of sign area for each lineal foot of building not to exceed the letter sizes in Section 1.7.

EXHIBIT 1-1

JAN-23-1999 08:35

W I L L I A M S D R

805 642 1220

P.02/02

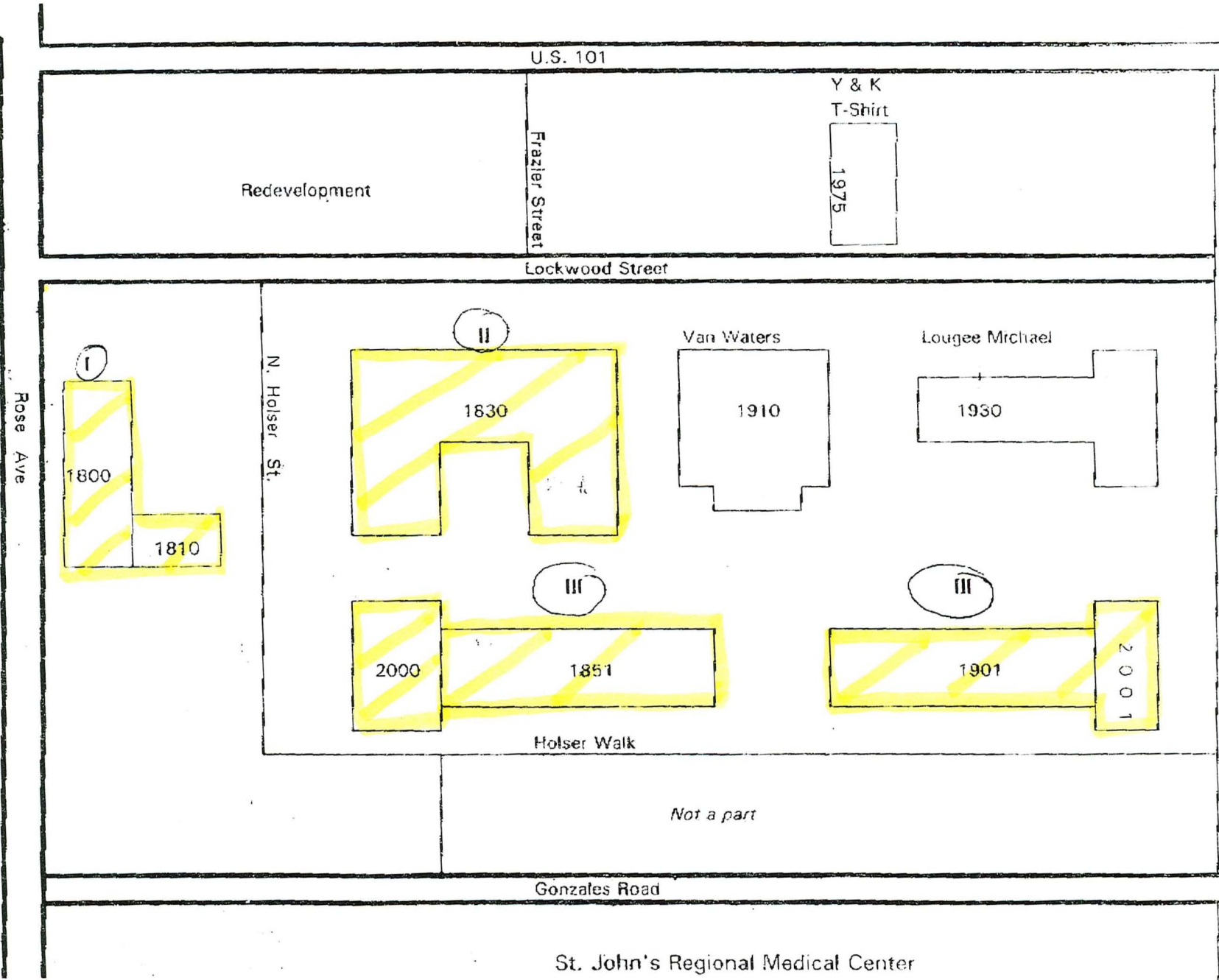

TOTAL P.02









